

Resurgence Half Marathon

Buffalo, NY



Certified Course
NY20003JJ

Effective: 3/23/2020
Through: 12/31/2030

Course Distance:	21.0975 km (Half Marathon)
Date Measured:	March 12, 2020
Measured By:	Jeff John <i>BuffaloRunners.com</i>
Calibration Course:	NY15045JJ
Notes:	This course was measured using the full width of the road and the Shortest Possible Route (SPR). Where a median is present (Erie St, and Fuhrmann Blvd) runners stay to the right. Maps not to scale. GPS coordinates use datum WGS84.
Legend:	<div style="display: flex; align-items: center;"> <div style="width: 20px; height: 10px; background-color: orange; margin-right: 5px;"></div> First 2 Miles of course </div> <div style="display: flex; align-items: center; margin-top: 5px;"> <div style="width: 20px; height: 10px; background-color: blue; margin-right: 5px;"></div> Middle Miles </div> <div style="display: flex; align-items: center; margin-top: 5px;"> <div style="width: 20px; height: 10px; background-color: red; margin-right: 5px;"></div> Final 6 Miles of course </div>

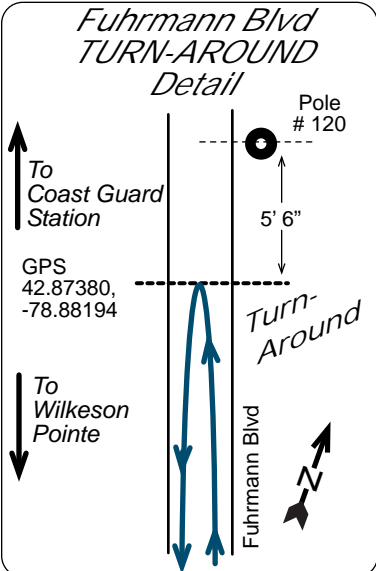
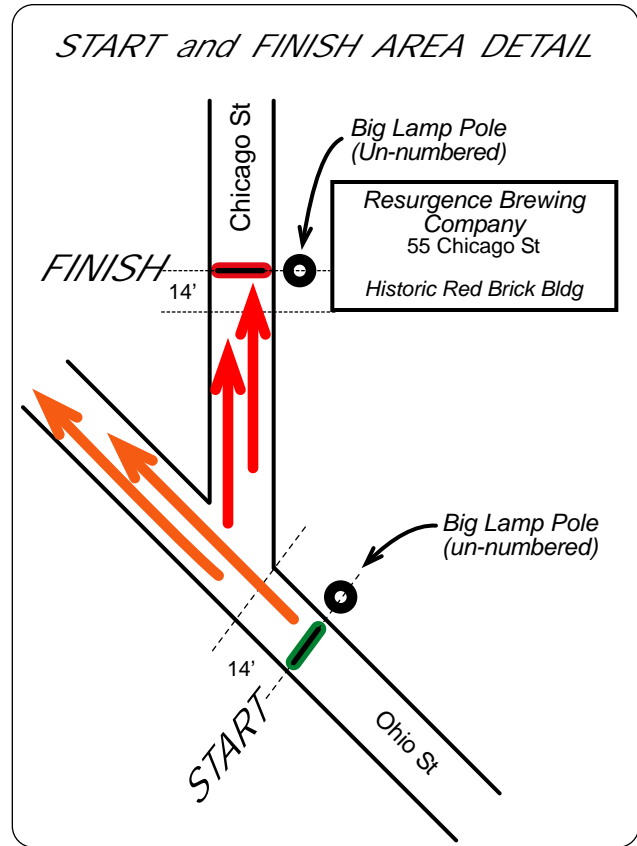
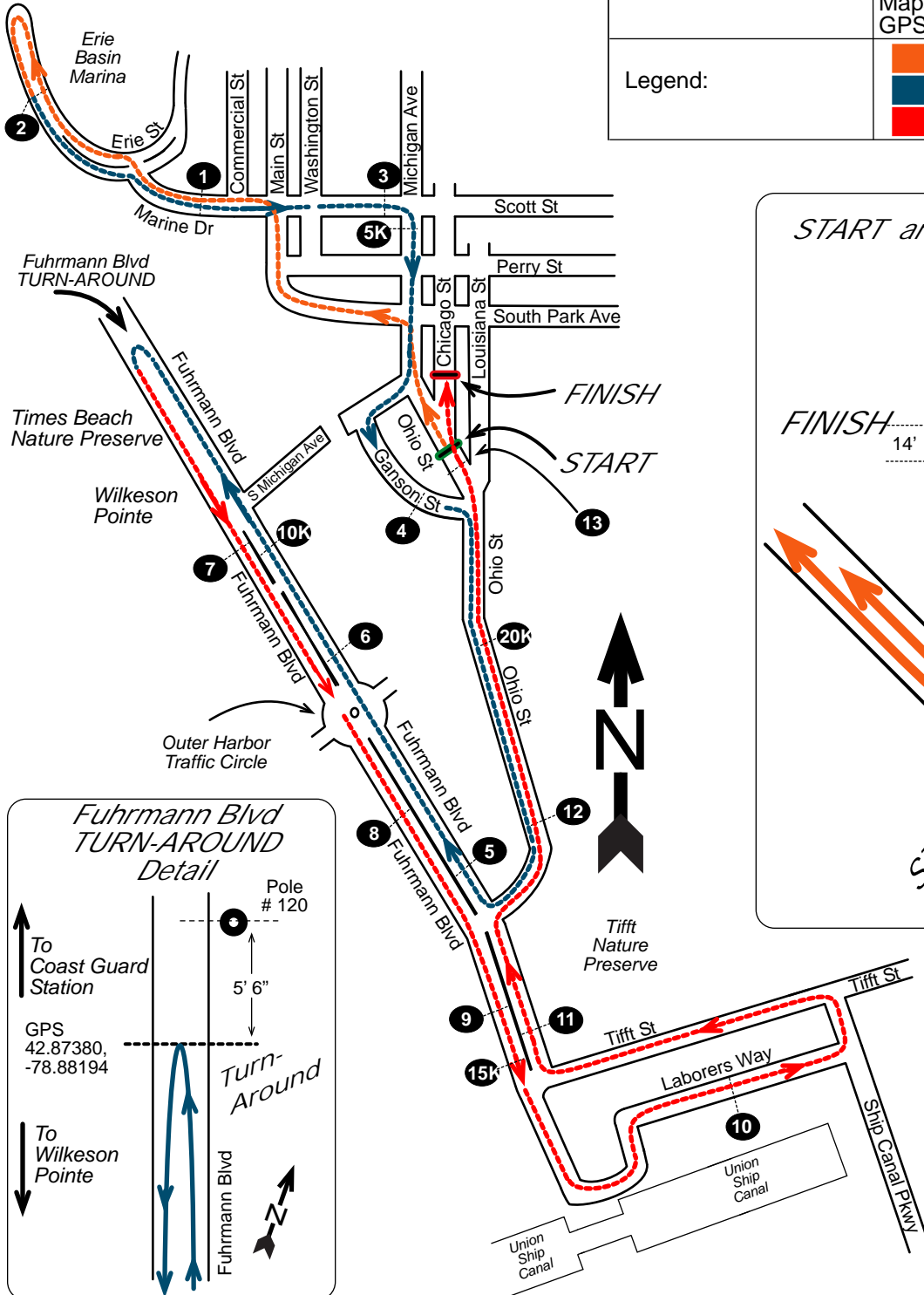

Splits on Map Page 2

Resurgence Half Marathon

START, FINISH, and Intermediate Splits

START	Ohio St at the vertical center of the 1st big lamp pole south of the intersection with Chicago St, 14 feet south of Chicago St.
1 MILE	Marine Dr, in-line with the bow of the USS The Sullivans (DD-537), and 54' past (north of) pole # 11.
2 MILE	Erie St, within the Erie Basin Marina, runners are exiting Marina, 39' past (south of) pole # 26.
3 MILE	Scott St, past the Buffalo News Bldg, near the HSBC Service Entrance, and 108' past (east of) pole # 176.
5K	On Michigan Ave, before Perry St, past Scott St, and 63' past (south of) pole # 176.
4 MILE	On Ganson St, past (south of) ADM Milling (250 Ganson), and 36' past pole # NG 187.
5 MILE	Fuhrmann Blvd just past the I-190 overpass tunnel, and 36' past (north of) median based pole # 986-1.
6 MILE	Fuhrmann Blvd, past the big traffic circle and before Bell Slip, and 57' past pole # 445-1.
10K	Fuhrmann Blvd, 120' before reaching the northern entrance to the Events Area.
T/A	Fuhrmann Blvd, north of Wilkeson Pointe, south of the CG station, 5' 6" south of lamp pole 120 and 40' north of pole NG 126, GPS 42.87380, -78.88194.
7 MILE	Fuhrmann Blvd near north entrance to Events Area, past S Michigan Ave, and 66 feet past pole NG 309.
8 MILE	Fuhrmann Blvd past the Bike Park, and 48 feet before pole 827, and before reaching the 3 rebar cylindrical towers.
9 MILE	Fuhrmann Blvd at Gallagher Beach, and 81 feet past pole 1361-1.
15K	Fuhrmann Blvd 129 feet before (north of) Tifft St, and 36 feet past (south of) pole 1543.
10 MILE	Laborers Way, 22 feet past (east of) pole 148 and 60 feet before (west of) pole 155.
11 MILE	1515 Fuhrmann Blvd (South End Marina), north of Tifft St, 30 feet past lamp pole 1525-1.
12 MILE	Ohio St 132 meters past Fuhrmann Blvd on south end of rise toward RR overpass, and 27 feet past lamp pole 861.
20K	658 Ohio St (Rigidized Metals) mid driveway of the truck entrance, south of Ganson St and north of Fuhrmann Blvd.
13 MILE	Ohio St, between South St and Chicago St, and 116.32 meters north of Dead Creek decorative bridge.
FINISH	FINISH at 55 Chicago St (Resurgence Brewery), at the vertical center of the big lamp pole, and 14 feet past (north of) the south edge of the rectangular red brick bldg of 55 Chicago St.